

Riduzione eccentrica a saldare lucida

Normativa: DIN 11851 (DIN 1)

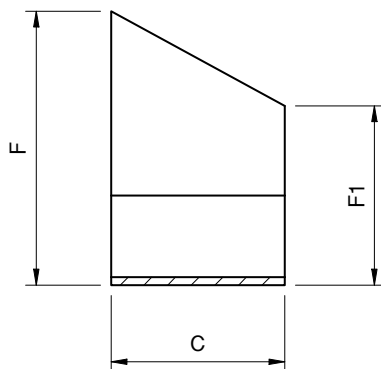

Fig. XD520.21

Codice	DN ₁ (mm)	DN ₂ (mm)	Ø F (mm)	Ø F ₁ (mm)	C (mm)
XD520.21015010.***	15	10	18	12	-
XD520.21020010.***	20	10	22	12	-
XD520.21020015.***	20	15	22	18	-
XD520.21025015.***	25	15	28	18	18
XD520.21025020.***	25	20	28	22	-
XD520.21032020.***	32	20	34	22	22
XD520.21032025.***	32	25	34	28	11
XD520.21040020.***	40	20	40	22	-
XD520.21040025.***	40	25	40	28	22
XD520.21040032.***	40	32	40	34	11
XD520.21050025.***	50	25	52	28	-
XD520.21050032.***	50	32	52	34	33
XD520.21050040.***	50	40	52	40	22
XD520.21065032.***	65	32	70	34	-
XD520.21065040.***	65	40	70	40	51
XD520.21065050.***	65	50	70	52	29
XD520.21080040.***	80	40	85	40	-
XD520.21080050.***	80	50	85	52	56
XD520.21080065.***	80	65	85	70	27
XD520.21100065.***	100	65	104	70	61
XD520.21100080.***	100	80	104	85	34
XD520.21101080.***	101	80	101.6	85	34
XD520.21125080.***	125	80	129	85	-
XD520.21125100.***	125	100	129	104	-
XD520.21150100.***	150	100	154	104	-
XD520.21150125.***	150	125	154	129	-

Materiale	Sigla (***)
Inox AISI 316	316