

Riduzione concentrica a saldare lucida

Normativa: DIN 11851 (DIN 1)

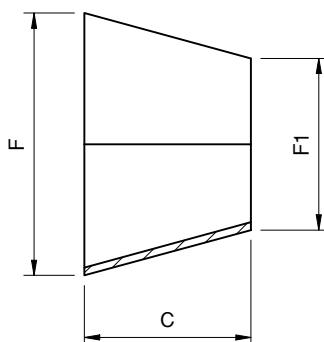

Fig. XD500.21

Codice	DN1 (mm)	DN2 (mm)	Ø F (mm)	Ø F1 (mm)	C (mm)
XD500.21015010.**	15	10	18	12	-
XD500.21020010.**	20	10	22	12	-
XD500.21020015.**	20	15	22	18	7
XD500.21025010.**	25	10	28	12	-
XD500.21025015.**	25	15	28	18	18
XD500.21025020.**	25	20	28	22	11
XD500.21032015.**	32	15	34	18	-
XD500.21032020.**	32	20	34	22	22
XD500.21032025.**	32	25	34	28	11
XD500.21040020.**	40	20	40	22	33
XD500.21040025.**	40	25	40	28	22
XD500.21040032.**	40	32	40	34	11
XD500.21050025.**	50	25	52	28	44
XD500.21050032.**	50	32	52	34	33
XD500.21050040.**	50	40	52	40	22
XD500.21065032.**	65	32	70	34	62
XD500.21065040.**	65	40	70	40	51
XD500.21065050.**	65	50	70	52	29
XD500.21080040.**	80	40	85	40	78
XD500.21080050.**	80	50	85	52	56
XD500.21080065.**	80	65	85	70	27
XD500.21100050.**	100	50	104	52	-
XD500.21100065.**	100	65	104	70	61
XD500.21100080.**	100	80	104	85	34
XD500.21101050.**	100	50	101.6	52	90
XD500.21101065.**	100	65	101.6	70	61
XD500.21101080.**	100	80	101.6	85	34
XD500.21125065.**	100	65	129	70	-
XD500.21125080.**	125	80	129	85	-
XD500.21125100.**	125	100	129	104	-
XD500.21150100.**	150	100	154	104	-
XD500.21150125.**	150	125	154	129	-

Materiale	Sigla (***)
Inox AISI 316	316